

# Exploded Views and Parts List

## INDOOR UNIT

AR09H5FNWKNET

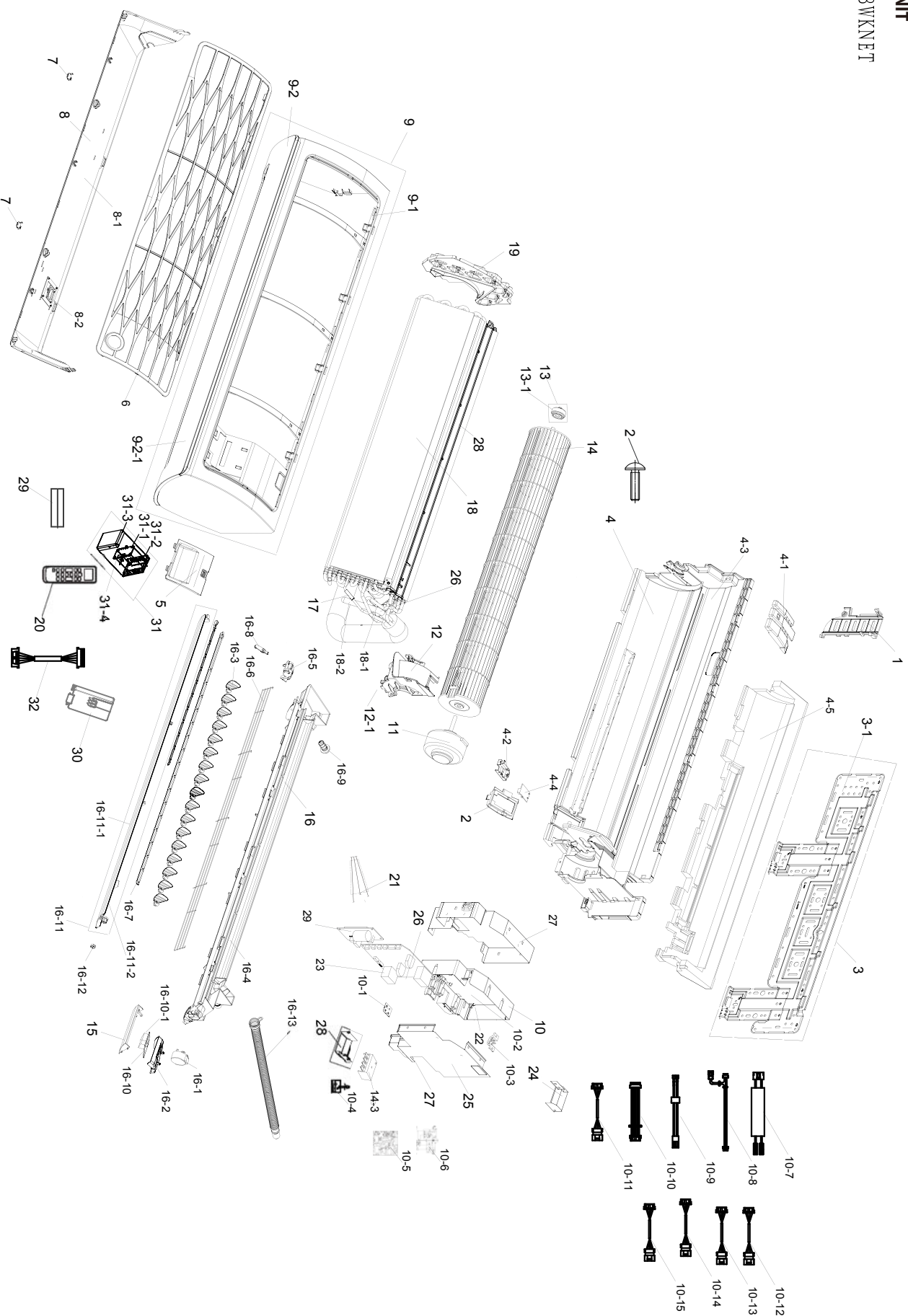

■ Parts List (03 FRAME PART LIST)

Exploded Views and Parts List

Parts Code	Level	Parts Description	Spec.	Quantity	Service
1	DB61-05853A	HOLDER-PIPE	A3050, F-RAC-04,HIPS	1	SA
2	DB97-02418A	ASSY-SCREW TAPPING	SS-P/J, TH, M4*L14	2	SA
3	DB90-07732A	ASSY HANGER	A3050 F-RAC-03,	1	SA
3-1	DB61-05958A	HANGER-LINK	F-RAC-03/04, GI-SGCC, T0. 6	1	SA
4	DB94-04159B	ASSY BACK BODY	AR12FCFSAWKNAF, ASSY, F03	1	SA
4-1	DB61-05849A	HOLDER	A3050, F-RAC-03/04/05	1	SA
4-2	DB61-05854A	CASE PCB-REMOCON	A3050, F-RAC-05, HIPS, -, BLACK	1	SNA
4-3	DB61-05831B	BODY BACK	F-RAC-03, ABS, T2. 3	1	SNA
4-4	DB92-02874A	ASSY PCB SUB	RECEIVER, A3050, 24*40	1	SA
4-5	DB62-11874A	SEAL CUSHION-BODY	EPS, WHITE, T10, W110, 682. 6	1	SNA
5	DB63-03494A	COVER PANEL-SUB	A3050, F-RAC-04, HIPS	1	SA
6	DB63-03523A	FILTER-PRE	A3050, F-RAC-03, ABS, DA WHITE	1	SNA
7	DB67-01404B	CAP-SCREW	A3050, F-RAC-04, HIPS	2	SNA
8	DB92-02894C	ASSY-COVER PANEL	A3050, F03, DA WHITE	1	SA
8-1	DB63-03494A	COVER PANEL-SUB	A3050, F-RAC-04, HIPS,	1	SA
8-2	DB64-03045A	BUTTON POWER	A3050, PC, MILK-WHITE	1	SA
9	DB92-02898B	ASSY PANEL FRONT	AR12FSFNWKNFA, ASSY, F03, , GOOD2	1	SA
9-1	DB92-02896A	ASSY PANEL FRONT SUB	AR09FCSDAWKNAF, ASSY, F03	1	SA
9-2	DB92-02899B	ASSY GRILLE	AR12FSFNWKNFA, F03, GOOD2	1	SA
9-3	DB64-02988D	GRILLE INLET	A3050 F-RAC-03, GOOD2, ABS	1	SA
10	DB93-14734M	ASSY CONTROL IN	HP, INV, 12K, AR12HSFNWVK/ET, SSEC	1	SNA
10-1	DB61-05812A	PLATE CONTROL-SUB	A3050 F-RAC-01/03/04/05	1	SA
10-2	DB61-05826A	CASE CONTROL-IN	A3050, F-RAC-03/F04, HIPS	1	SNA
10-3	DB61-05871A	HOLDER-WIRE	A3050, ABS, EBONY BLACK,	1	SNA
10-4	DB65-00326A	TERMINAL BLOCK	4P, PBT, 4-TAB, 4-SCREW	1	SA
10-5	DB92-02873C	ASSY PCB MAIN	INDOOR, INVERTER, BEST	1	SA
10-6	DB92-02861A	ASSY MODULE	STD #3 SMPS, A3050	1	SA
10-7	DB93-14203A	ASSY CONNECTOR WIRE-POWER	2, 1015, 22, BRN, YH396-03V/BLU	1	SA
10-8	DB93-06677A	ASSY CONNECTOR WIRE	2, 1015, 22, BRN, YH396-03V/WHT	1	SA
10-9	DB93-14207B	ASSY CONNECTOR WIRE-DC SIGNAL	4, 1007, 24, RED, SMH250-03L/WHT	1	SA
10-10	DB93-14208A	ASSY CONNECTOR WIRE-DC SIGNAL	3, 1007, 26, RED, SMH250-05L/RED	1	SA
10-11	DB93-14211A	ASSY CONNECTOR WIRE-DC SIGNAL	6, 2095, 26, RED, SMH200-06H/RED	1	SA
10-12	DB93-14221A	ASSY CONNECTOR WIRE-DC SIGNAL	10, 2095, 26, RED, SMH200-14H/WHT	1	SA
10-13	DB93-14723A	ASSY CONNECTOR WIRE-DC SIGNAL	5, 2095, 24, RED, SMH250-05L/WHT	1	SA
10-14	DB93-14724A	ASSY CONNECTOR WIRE-MOTOR	5, 1015, 22, RED, YH396-H06PL/WHT	1	SA
10-15	DB93-14209A	ASSY CONNECTOR WIRE-DISPLAY	11, 2095, 26, RED, SMH200-11H/WHT	1	SA
11	DB31-00636A	MOTOR BLDC FAN	RD-310-25-8A (AL), 1450, 310V, 1, 25	1	SA
12	DB90-07859C	ASSY PLATE-CONTROL	F03/04, ASSY, SSEC	1	SA
12-1	DB63-03492A	COVER MOTOR	A3050, F-RAC-04, ABS, -	1	SA
13	DB94-00455B	ASSY-RUBBER BEARING	WW-PJT, CR, BLK SSEC	1	SC
13-1	DB94-40007B	ASSY-BEARING	G1-PJT, SSEC	1	SNA
14	DB94-01550D	ASSY FAN CROSS	A3050, 95. 6PI, BLACK	1	SA
15	DB90-07851A	ASSY COVER DISPLAY	AR12FSSSBWKNFA, ASSY	1	SNA
16	DB94-04160C	ASSY TRAY DRAIN	AR12HSFSAWKNET, ASSY, F03	1	SA
16-1	DB31-00369D	MOTOR STEP	DB31-00369D, 35BYJ46,	1	SA
16-2	DB61-05827A	CASE-DISPLAY	F01/F03/F04/F05, HIPS,	1	SA
16-3	DB61-05846A	BLADE V	F-RAC-03/04/05, ABS, TWILIGHT BLUE	15	SA
16-4	DB63-03501A	TRAY DRAIN	F-RAC-03, HIPS, T2. 0, BLACK	1	SNA
16-5	DB61-05872A	GUIDE BLADE	A3050, F-RAC-04, HIPS	1	SA
16-6	DB63-03663A	GUARD-SCREEN	A3050 F-RAC-03/09,	1	SNA
16-7	DB66-01728A	LINK BLADE-A	A3050, F-RAC-03, POM, BLACK	1	SA
16-8	DB66-01730A	LINK BLADE-B	A3050, F-RAC-04, POM, NATURAL	1	SA
16-9	DB73-00180B	RUBBER-CAP DRAIN	all moel, NR, D22, 40, 40, RAC	1	SA
16-10	DB92-02877A	ASSY PCB DISPLAY	BETTER, BEST, A3050, 64*36	1	SA
16-11	DB64-02991A	WINDOW DISPLAY	A3050, F-RAC-03/04, PC,	1	SA
16-12	DB92-02897A	ASSY BLADE H	AR09FCSDAWKNAF, ASSY, F03	1	SA
16-13	DB61-05832A	BLADE H-TOP	A3050, F-RAC-03, ABS, DA WHITE	1	SNA
16-14	DB61-05833A	BLADE H-BOTTOM	A3050, F-RAC-03, ABS, DA WHITE	1	SNA
16-15	DB61-03132A	HOLDER-BLADE OUT	HP-C180V, STS304, 0. 5,	1	SNA
16-16	DB94-00458H	ASSY HOSE DRAIN	A3050-PJT, SSEC	1	SA
17	DB67-60030A	SPRING-SENSOR	WW2-PJT, STS301, 0. 4, T0. 4, W2. 7	2	SA
18	DB96-19014C	ASSY EVAP TOTAL	F03, SSEC	1	SA
18-1	DB96-18900A	ASSY TUBE EVAP IN	AR09FCSDAWKNAF, F03, SSEC	1	SA
18-2	DB96-18901A	ASSY TUBE EVAP OUT	AR09FCSDAWKNAF, F03, SSEC	1	SA
18-3	DB60-30010B	FASTENER-NUT FLARE	C3771BD, HEX, 5/8-18UNF	1	SA
19	DB63-03511A	COVER EVAP	A3050 F-RAC-03, PP, T2. 0, -,	1	SNA
20	DB93-14195A	ASSY WIRELESS REMOCON	RS-1, ENGLISH, 37. 0*25. 0, °C, RAC	1	SA
21	DB93-14245A	ASSY CONNECTOR WIRE-EARTH	1, 1015, 16, YEL/GRN, ST710095-3	1	SA
22	DB61-05963A	SUPPORT-CONTROL	A3050, F-RAC-03, HIPS, F744, BLACK	1	SA
23	DB95-05163A	ASSY THERMISTOR IN	103HW, 6P, 400/400/400	1	SA
24	DB61-05965A	PLATE CONTROL-UP	A3050 F-RAC-03, GI-SGCC	1	SA
25	DB61-05959A	PLATE CONTROL-RIGHT	A3050, F-RAC-03/04, GI-SGCC	1	SA
26	DB67-01431A	RUBBER PIPE	AR12FSSSBWKNFA, SIR, 8	1	SA
27	DB90-07861A	ASSY PLATE-MIDDLE	AR09FCSDAWKNAF, F03, SSEC	1	SA
28	DB61-05829A	HOLDER EVAP	A3050, F-RAC-04, ABS, T2	1	SNA
29	4301-00012I	BATTERY-MN	1. 5V, R03, 10. 5x44. 5m, 7. 5g, AAA	2	SNA
30	DB61-06101A	CASE PCB-LOW	A3050 Common, HIPS, BLACK, V0, S834S1	1	SNA
31	DB90-07763A	ASSY-WIFI KIT	AR18FSSSBWVK/SA, SSEC	1	SNA
31-1	4709-002176	W-LAN MODULE	SWL-B70F, 802. 11n, 2. 4GHz	1	SNA
31-2	DB61-05847A	CASE PCB	A3050 F-RAC-04, HIPS, -	1	SA
31-3	DB63-03503A	COVER PCB	A3050 F-RAC-04, HIPS, -	1	SA
31-4	DB92-02875A	ASSY PCB SUB	WIFI DC-DC CONVERTER	1	SA
32	DB93-14206A	ASSY CONNECTOR WIRE-DC SIGNAL	4, 2095, 26, ORG,	1	SA