

7. EXPLODED VIEW AND PARTS LIST

7-1. Total Exploded View

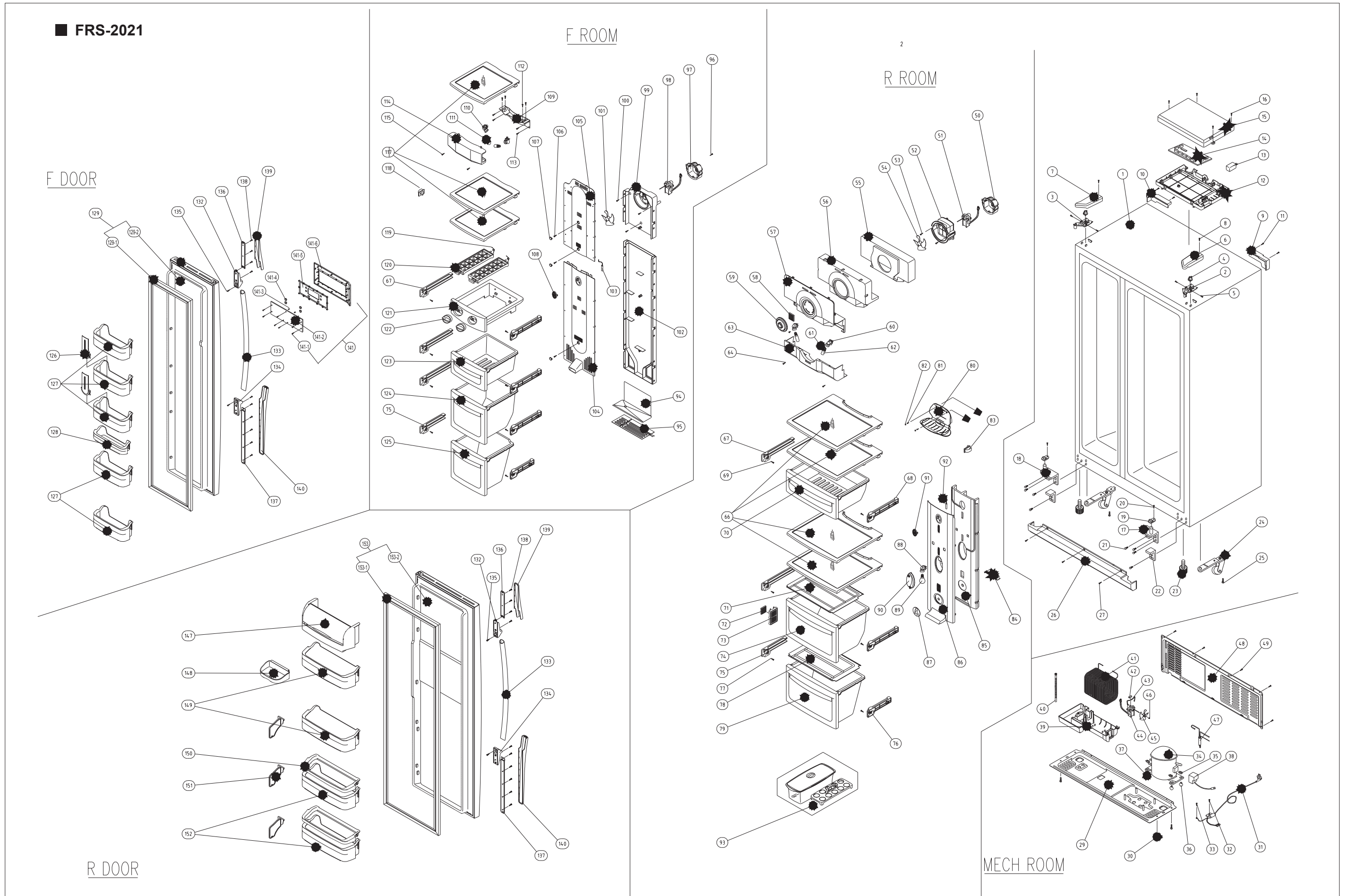

7-2. Total Parts List

■ FRS-2021

✓ **Caution:** In this Service Manual, some parts can be changed for improving, their performance without notice in the parts list. So, if you need the latest parts information, please refer to PPL(Parts Price List) in Service information Center(<http://svc.dwe.co.kr>)

NO	PART CODE	PART NAME	PART DESCRIPTION	QUANTITY	REMARK
1	3000003600	ASSY CAB URT		1	
2	3012917600	HINGE *T *R AS	PO T3.0	1	
3	3012918500	HINGE *T *L AS	PO T3.0	1	
4	3012013000	FIXTURE *T HI	PP	2	
5	3016031300	SPECIAL *T HI BOLT	SWCH10A M5 x 10.5	4	
6	3011472400	COVER HI *T *R	PP	1	
7	3011472300	COVER HI *T *L	PP	1	
8	7112401211	SCREW TAPPING	T1 TRS 4 x 12 MFZN	2	
9	3012601301	HANDLE CAB COVR *R	PP	1	
10	3012601201	HANDLE CAB COVR *L	PP	1	
11	7112401211	SCREW TAPPING	T1 TRS 4 x 12 MFZN	1	
12	3010533400	BOX MAIN PCB	PP	1	
13	3016401170	CAPACITOR RUN		1	
14	30143B4010	PCB MAIN AS		1	
15	3011472610	COVER MAIN PCB BOX	PP	1	
16	7112401211	SCREW TAPPING	T1 TRS 4 x 12 MFZN	1	
17	3012917810	HINGE *U *R AS	PO T5.0+PAINTING	1	
18	3012917710	HINGE *U *L AS	PO T5.0+PAINTING	1	
19	3012513300	GUIDE *U HINGE *U	POM	2	
20	7002501611	SCREW MACHINE	TRS M5 x 16 MFZN	2	
21	3016001240	SPECIAL BOLT *T	6 x 22 SWCH22A(YL)	8	
22	3015306700	SUPPORTER *U HI AS	PO T5.0	2	
23	3012104400	FOOT ADJUST AS		2	
24	3016501200	CASTER TURN AS	TURN CASTER	2	
25	3016001240	SPECIAL BOLT *T	6 x 22 SWCH22A(YL)	2	
26	3011471010	COVER CAB BRKT	PP	1	
27	7142401611	SCREW TAPPING	T2 TRS 4 x 16 MFZN	3	
29	3010326700	BASE COMP AS	SBHG T1.2	1	
30	3016003300	SPECIAL BOLT	T2 M6.5 x 20 4EA	4	
31	3011344200	CORD POWER AS	250V 12A	1	
32	7112401211	SCREW TAPPING	T1 TRS 4 x 12 MFZN	1	
33	7051401065	SCREW MACHINE	PAN 4 x 10 SW BSNI	1	
34	3956183D40	COMP	MK183B-L2U	1	
35	3016002500	SPECIAL WASHER	SK-5 T0.8	4	
36	3010101440	ABSORBER COMP AS		4	
38	3817925100	RELAY STARTING	J1531Q34E220M3502 RSCR S/S	1	
39	3011113500	CASE VAPORI	PP + CTALC	1	
40	3013201700	HOSE DRAIN	PEHD	1	
41	3014413730	PIPE WICON AS		1	
42	3010102100	ABSORBER C MOTR	NR FRB-5350NT	1	
43	3012004400	FIXTURE C MOTR	SUS	1	
44	3015911500	MOTOR C FAN AS	DC12V 2.5W	1	
45	3011802200	FAN	ABS (O.D.)3.17 x D110	1	
46	3011200500	CLAMP FAN	SUS 304	1	
47	3016806900	DRYER AS	XH-9 15g	1	
48	3011474710	COVER MACH ROOM AS	SBHG T0.4	1	
49	7112401211	SCREW TAPPING	T1 TRS 4 x 12 MFZN	6	
50	3012007800	FIXTURE MOTOR A	PP	1	
51	3015911400	MOTER R FAN AS		1	

NO	PART CODE	PART NAME	PART DESCRIPTION	QUANTITY	REMARK
52	3012007900	FIXTURE MOTOR B	HIPS	1	
53	7122401211	SCREW TAPPING	T2S TRS 4 x 12 MFZN	2	
54	3011802200	FAN	ABS (O.D.)3.17 x D110	1	
55	3013344200	INSU DAMP B	F-PS	1	
56	3013344100	INSU DAMP A	F-PS	1	
57	3011471200	COVER DAMP	HIPS	1	
58	3018701800	DEO ANTI AS		1	
59	3011471310	COVER DEO	ABS	1	
60	3017905300	SOCKET R LAMP AS		2	
61	7121300811	SCREW TAPPING	T2S PAN 3 x 8	1	
62	3013602000	LAMP R A	AC240V 25W	2	
63	3015507900	WINDOW R LAMP A	MIPS	1	
64	3016002710	SPECIAL SCREW	4 x 12	2	
66	3017827300	SHELF R A AS	GLASS + HIPS	4	
67	3012514500	GUIDE CASE A *L AS	ABS	2	
68	3012514600	GUIDE CASE A *R AS	ABS	2	
69	7142401611	SCREW TAPPING	T2 TRS 4 x 16 MFZN	4	
70	3011171200	CASE CHILD AS	GPPS + HIPS	1	
71	3011473100	COVER VEGETB CASE A	GPPS	1	
72	3018701800	DEO ANTI AS		1	
73	3011472900	COVER RETURN DUCT	HIPS	1	
74	3011172000	CASE VEGETB A AS	GPPS + HIPS	1	
75	3012514700	GUIDE CASE B *L AS	ABS	1	
76	3012514800	GUIDE CASE B *R AS	ABS	1	
77	7142401611	SCREW TAPPING	T2 TRS 4 x 16 MFZN	2	
78	3011473200	COVER VEGETB CASE B	GPPS	1	
79	3011172100	CASE VEGETABLE B AS	GPPS + HIPS	1	
80	3017827500	SHELF WINE AS	ABS	1	
81	3016002710	SPECIAL SCREW	4 x 12	2	
82	3010903200	CAP SCREW	PE	2	
83	3018124000	SWITCH LAMP	SP201R-7DR	1	
84	3017100500	FLAP MULT DUCT	PP	1	
85	3013345000	INSU MULT DUCT AS	F-PS	1	
86	3011472700	COVER MULT DUCT	HIPS	1	
87	3013408100	KNOB MULT DUCT	ABS	1	
88	3017905310	SOCKET R LAMP AS	250V 1A	1	
89	3013600020	LAMP R B	AC240V 15W	1	
90	3015508000	WINDOW R LAMP B	MIPS	1	
91	3011473000	COVER SENS	ABS	1	
92	3014805400	SENSOR R AS	PBN-438	1	
93	3011171300	CASE EGG AS	GPPS	1	
94	3012514200	GUIDE DRN	GA	1	
95	3012811100	HEATER DRN GUIDE AS	220V/ 45W	1	
96	7112401211	SCREW TAPPING	T1 TRS 4 x 12 MFZN	1	
97	3012007800	FIXTURE MOTOR A	PP	1	
98	3015911300	MOTOR F FAN AS	DC12V 2.5W	1	
99	3018914400	LOUVER F C	PP	1	
100	7142401611	SCREW TAPPING	T2 TRS 4 x 16 MFZN	3	
101	3011802200	FAN	ABS (O.D.)3.17 x D110	1	
102	3018914900	LOUVER F D AS	PP	1	
103	3014805300	SENSOR F AS	PT-38	1	
104	3018914700	LOUVER F B AS	HIPS	1	
105	3018914610	LOUVER F A AS	HIPS	1	
106	7142401611	SCREW TAPPING	T2 TRS 4 x 16 MFZN	3	
107	3010924600	CAP F LUVR	HIPS	3	
108	3011473000	COVER SENS	ABS	1	

NO	PART CODE	PART NAME	PART DESCRIPTION	QUANTITY	REMARK
109	3014559510	PLATE LAMP F	SBHG T0.8	1	
110	3017905200	SOCKET F LAMP AS		2	
111	3013602000	LAMP F	AC240V 25W	2	
112	7121300811	SCREW TAPPING	T2S PAN 3X8 MFZN	4	
113	7112401211	SCREW TAPPING	T1 TRS 4 x 12 MFZN	4	
114	3015507710	WINDOW F LAMP	MIPS	1	
115	3016002710	SPECIAL SCREW	4 x 12	2	
117	3017827100	SHELF F A AS	GLASS + HIPS	3	
118	3018124000	SWITCH LAMP	SP201R-7DR	1	
119	3015101300	SPRING ICING CASE	STS304WPB	2	
120	3011170600	CASE ICING	PP	2	
121	3012203800	FRAME ICE MAKER	ABS	1	
122	3013408000	KNOB ICEING CASE	HIPS	2	
123	3011171800	CASE ICE AS	GPPS + HIPS	1	
124	3011171400	CASE F A AS	GPPS + HIPS	1	
125	3011171500	CASE F B AS	GPPS + HIPS	1	
126	3012516000	GUIDE F POCKET	PP	2	
127	3019019100	POCKET F *U	HIPS	5	
128	3019019000	POCKET F *T	HIPS	1	
129	3000018700	ASSY F DR	FRS-2021	1	
129-1	3012314200	GASKET F DR AS	PVC	1	
129-2	3000003700	ASSY F DR URT		1	
132	3011623800	DECO HNDL *T	ABS	1	
133	3012628500	HANDLE	AL	1	
134	3011613900	DECO HNDL *U	ABS	1	
135	3016031700	SPECIAL SCREW		2	
136	3010326100	BASE DECO COVER *T	HIPS	1	
137	3010326200	BASE DECO COVER *U	HIPS	1	
138	7112401211	SCREW TAPPING	T1 TRS 4 x 12 MFZN	8	
139	3011472100	COVER HNDL DECO *T	ABS	1	
140	3011472200	COVER HNDL DECO *U	ABS	1	
141	3011747510	COVER F PCB AS	FRS-2021	1	
141-1	7111300811	SCREW TAPPING	T1 PAN 3 x 8 MFZN	7	
141-2	30143B4110	PCB F AS		1	
141-3	3016302600	BUTTON CONTL B	ABS	2	
141-4	3016303100	BUTTON CONTL A	ABS	4	
141-5	3015507800	WINDOW F PCB	ABS	1	
141-6	3011471600	COVER F PCB	ABS	1	
147	3019019400	POCKET DAIRY AS	GPPS + HIPS	1	
148	3019019300	POCKET R *S	GPPS	1	
149	3019019800	POCKET R *M	HIPS	2	
150	3012514100	GUIDE R POKT	HIPS	2	
151	3012513400	GUIDE BOTL	PP	2	
152	3019019200	POCKET R	HIPS	2	
153	3000018800	ASSY R DR	FRS-2021	1	
153-1	3012314500	GASKET R DR AS	PVC	1	
153-2	3000003800	ASSY R DR URT		1	